

August 2025 | Product Catalog

# Wavin A-Pex Plumbing System

Potable water pipes for cold expansion and crimp connections





A photograph of a modern, multi-story apartment building with a courtyard. The building has a dark facade with many windows and balconies. The courtyard in the foreground has a wooden deck, a paved path, and some greenery. The sky is a deep blue with some clouds.

# Wavin

## Global Leader in Plastic Pipes & Fittings

Wavin is a leading supplier and manufacturer of plastic pipes and fittings for plumbing, waste and sewer systems, roof drainage, stormwater management, smart water management solutions, water reuse systems, and underfloor heating.

Backed by more than 60 years of product development experience, Wavin (pronounced “wah-vin”) advances life around the world by building healthy, sustainable environments for people everywhere.

## Building Better Since 1955





# Table of Contents

---

<b>Features and Benefits</b>	<b>4</b>
<b>Standards and Certifications</b>	<b>5</b>
<b>Potable Water Pipes</b>	<b>6</b>
<b>Fittings</b>	<b>8</b>
Brass Cold Expansion Fittings	8
PPSU Cold Expansion Fittings	12
Brass Crimp Fittings	15
PPSU Crimp Fittings	20
<b>Warranty</b>	<b>23</b>

# Features and Benefits

Wavin A-Pex tubing is manufactured for use in hot and cold potable water distribution.

Our pex-a offering is the apex of advanced PEX piping, with an industry-leading **25-year warranty** on the system. Ideal for colder temperatures, Wavin A-Pex is pressure-resistant to mitigate the risk of burst pipes during cold winters. Its flexibility makes it ideal in multifamily residential, industrial, commercial, and high-rise, applications.

The Wavin A-Pex pipe is versatile offering connections that can be made through expansion and crimping to accommodate your preference and comfort level.

## Wavin A-Pex Pipe



### DUOLAYER

Multilayered pipe for maximum durability and UV protection



### FLEXIBLE

Superior flexibility, making it easy to install and service.



### QUIET

Reduces noise caused by water hammer, resulting in a quieter system compared to copper.



### CORROSION RESISTANT

Resists corrosion and scale buildup, enhancing plumbing system performance and durability.



### COST EFFECTIVE

Requires fewer fittings, reducing total installation costs.



### EASY TO INSTALL

The lightweight pipe allows faster pressure testing without waiting for glue to dry or joints to cool. Most importantly, plastic piping systems have no adverse effect on water quality.

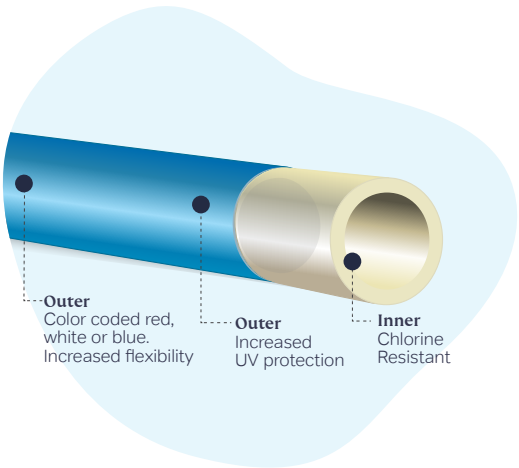

## PEX Expansion and Crimp Fittings

Superior connections with quality materials.

F1960 Expansion Fittings, F1807 Lead-free brass crimp fittings and F2159 pollyalloy crimp fittings provide secure connections for any project.





## Wavin A-Pex Plumbing System

# Standards and Certifications

### Wavin A-Pex Pipe (PEX-a)

- CSA B137.5
- ASTM F876
- ASTM F877
- NSF 14; NSF 61; cNSF®us pw



\*ICC Evaluation Service product certificate PMG-1559

\*CAN/ULC -S102.2

\*ASTM E84

For detailed information, please refer to:

\*ICC -ES PMG-1559

### Chlorine resistance and UV protection:

Chlorine, UV, and Hydrostatic Design Stress (HDS) rating of pipe:  
PEX material designation code PEX 5206.

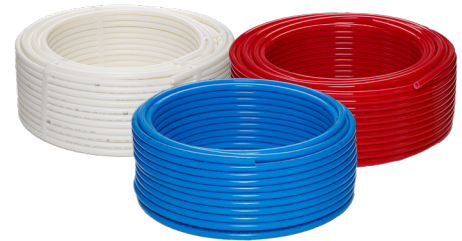
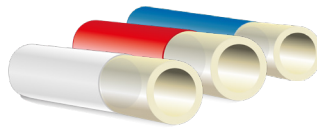

### Compatible Fittings

ASTM F1960; ASTM F1807; ASTM F2159

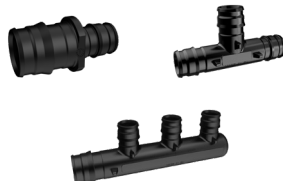



# Potable Water Pipes

A-Pex Potable Water Duolayer Pipe  
White Coils



Item Number	Description	Pallet QTY
660118	½" x 100ft White Coil	52
660126	½" x 300ft White Coil	25
660134	½" x 500ft White Coil	20
660274	¾" x 100ft White Coil	25
660282	¾" x 300ft White Coil	15
660332	¾" x 500ft White Coil	10
660480	1" x 100ft White Coil	25
660498	1" x 300ft White Coil	10
660530	1 ¼" x 100' White Coil	13
660548	1 ¼" x 300' White Coil	5
660555	1 ½" x 100' White Coil	10
660571	1 ½" x 300' White Coil	4
660605	2" x 100' White Coil	4
660613	2" x 200' White Coil	5
660621	2" x 300' White Coil	5

A-Pex Potable Water Duolayer Pipe  
White Straights

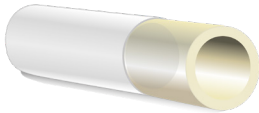

Item Number	Description	Sales Pack	Pipes Per Unit	Master Pack	Master Pack QTY
660175	½" x 20' White Straight Lengths	Plastic Bag	25	Bundle Bag	15
660365	¾" x 20' White Straight Lengths	Plastic Bag	10	Bundle Bag	15
660522	1" x 20' White Straight Lengths	Plastic Bag	5	Bundle Bag	15
660639	1 ¼" x 20' White Straight Lengths	Plastic Bag	5	Bundle Bag	10
660647	1 ½" x 20' White Straight Lengths	Plastic Bag	5	Bundle Bag	10
660654	2" x 20' White Straight Lengths	Plastic Bag	5	Bundle Bag	10



# Potable Water Pipes

A-Pex Potable Water Duolayer Pipe  
Red Coils



Item Number	Description	Pallet QTY
660050	½" x 100ft Red Coil	52
660068	½" x 300ft Red Coil	25
660100	½" x 500ft Red Coil	20
660241	¾" x 100ft Red Coil	25
660258	¾" x 300ft Red Coil	15
660266	¾" x 500ft Red Coil	10
660423	1" x 100ft Red Coil	25
660431	1" x 300ft Red Coil	10

A-Pex Potable Water Duolayer Pipe  
Red Straights

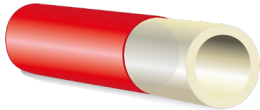

Item Number	Description	Sales Pack	Pipes Per Unit	Master Pack	Master Pack QTY
660159	½" x 20' Red Straight Lengths	Plastic Bag	25	Bundle Bag	15
660357	¾" x 20' Red Straight Lengths	Plastic Bag	10	Bundle Bag	15
660514	1" x 20' Red Straight Lengths	Plastic Bag	5	Bundle Bag	15

A-Pex Potable Water Duolayer Pipe  
Blue Coils



Item Number	Description	Pallet QTY
660001	½" x 100ft Blue Coil	52
660019	½" x 300ft Blue Coil	25
660027	½" x 500ft Blue Coil	20
660191	¾" x 100ft Blue Coil	25
660225	¾" x 300ft Blue Coil	15
660233	¾" x 500ft Blue Coil	10
660381	1" x 100ft Blue Coil	25
660399	1" x 300ft Blue Coil	10

A-Pex Potable Water Duolayer Pipe  
Blue Straights

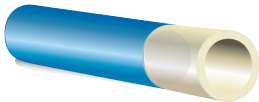

Item Number	Description	Sales Pack	Pipes Per Unit	Master Pack	Master Pack QTY
660142	½" x 20' Blue Straight Lengths	Plastic Bag	25	Bundle Bag	15
660340	¾" x 20' Blue Straight Lengths	Plastic Bag	10	Bundle Bag	15
660506	1" x 20' Blue Straight Lengths	Plastic Bag	5	Bundle Bag	15



# Brass Cold Expansion Fittings

## F1960 Brass Expansion Coupling

Lead-Free Brass Fittings



Item Number	Description	Size	Sales Pack (Bag QTY)	Box QTY
690008	½" Brass Coupling	½" x ½"	25	500
690016	¾" Brass Coupling	¾" x ¾"	25	200
690024	1" Brass Coupling	1" x 1"	10	100
690032	1 ¼" Brass Coupling	1 ¼" x 1 ¼"	2	50
690040	1 ½" Brass Coupling	1 ½" x 1 ½"	2	50
690057	2" Brass Coupling	2" x 2"	2	20

## F1960 Brass Expansion Reducing Coupling

Lead-Free Brass Fittings



Item Number	Description	Size A	Size B	Sales Pack (Bag QTY)	Box QTY
690065	¾" x ½" Brass Reducing Coupling	½"	¾"	25	200
690073	1" x ¾" Brass Reducing Coupling	¾"	1"	10	100
690081	1 ¼" x 1" Brass Reducing Coupling	1"	1 ¼"	2	50
690099	1 ½" x 1" Brass Reducing Coupling	1"	1 ½"	2	50
690107	1 ½" x 1 ¼" Brass Reducing Coupling	1 ¼"	1 ½"	2	50
690115	2" x 1 ¼" Brass Reducing Coupling	1 ¼"	2"	2	30
690123	2" x 1 ½" Brass Reducing Coupling	1 ½"	2"	2	30

## F1960 Brass Expansion Adapter MPT

Lead-Free Brass Fittings



Item Number	Description	Size A	Size B	Sales Pack (Bag QTY)	Box QTY
690131	½" x ½" Brass Adapter MPT	½"	½"	25	300
690149	½" x ¾" Brass Adapter MPT	½"	¾"	25	250
690156	¾" x ½" Brass Adapter MPT	¾"	½"	25	200
690164	¾" x ¾" Brass Adapter MPT	¾"	¾"	25	200
690172	¾" x 1" Brass Adapter MPT	¾"	1"	10	100
690180	1" x ¾" Brass Adapter MPT	1"	¾"	10	150
690198	1" x 1" Brass Adapter MPT	1"	1"	10	100

**Lead free:** Brass that conforms with NSF/ANSI 372 and U.S. Safe Drinking Water Act of the United States.



# Brass Cold Expansion Fittings

## F1960 Brass Expansion Adapter FPT

Lead-Free Brass Fittings



Item Number	Description	Size A	Size B	Sales Pack (Bag QTY)	Box QTY
690206	1/2" x 1/2" Brass Adapter FPT	1/2"	1/2"	25	300
690214	1/2" x 3/4" Brass Adapter FPT	1/2"	3/4"	25	200
690222	3/4" x 3/4" Brass Adapter FPT	3/4"	3/4"	25	200
690230	3/4" x 1" Brass Adapter FPT	3/4"	1"	10	100
690248	1" x 1" Brass Adapter FPT	1"	1"	10	100

## F1960 Brass Expansion Male Sweat Adapter

Lead-Free Brass Fittings



Item Number	Description	Size A	Size B	Sales Pack (Bag QTY)	Box QTY
690255	1/2" x 1/2" Brass Male Sweat Adapter	1/2"	1/2"	25	500
690263	3/4" x 3/4" Brass Male Sweat Adapter	3/4"	3/4"	25	250
690271	3/4" x 1" Brass Male Sweat Adapter	3/4"	1"	10	150
690289	1" x 1" Brass Male Sweat Adapter	1"	1"	10	150

## F1960 Brass Expansion Female Sweat Adapter

Lead-Free Brass Fittings



Item Number	Description	Size A	Size B	Sales Pack (Bag QTY)	Box QTY
690297	1/2" x 1/2" Brass Female Sweat Adapter	1/2"	1/2"	25	500
690305	3/4" x 3/4" Brass Female Sweat Adapter	3/4"	3/4"	25	250
690313	1" x 1" Brass Male Sweat Adapter	1"	1"	10	100

## F1960 Brass Expansion Elbow

Lead-Free Brass Fittings



Item Number	Description	Size A	Size B	Sales Pack (Bag QTY)	Box QTY
690321	1/2" x 1/2" Brass Elbow	1/2"	1/2"	25	250
690339	3/4" x 1/2" Brass Elbow	3/4"	1/2"	25	200
690347	3/4" x 3/4" Brass Elbow	3/4"	3/4"	15	150
690354	1" x 1" Brass Elbow	1"	1"	10	80
690362	1 1/4" x 1 1/4" Brass Elbow	1 1/4"	1 1/4"	2	50
690370	1 1/2" x 1 1/2" Brass Elbow	1 1/2"	1 1/2"	2	30
690388	2" x 2" Brass Elbow	2"	2"	2	20

**Lead free:** Brass that conforms with NSF/ANSI 372 and U.S. Safe Drinking Water Act of the United States.

# Brass Cold Expansion Fittings

## F1960 Brass Expansion Drop Ear

Lead-Free Brass Fittings



Item Number	Description	Size	Sales Pack (Bag QTY)	Box QTY
690396	½" x ½" Brass Drop Ear FPT	½"	10	150
690495	¾" x ¾" Brass Drop Ear FPT	¾"	10	100

## F1960 Brass Expansion Elbow MPT

Lead-Free Brass Fittings



Item Number	Description	Size	Sales Pack (Bag QTY)	Box QTY
690503	½" x ½" Brass Elbow MPT	½"	25	200

## F1960 Brass Expansion Tee

Lead-Free Brass Fittings



Item Number	Description	Size A	Size B	Size C	Sales Pack (Bag QTY)	Box QTY
690511	½" Brass Tee	½"	½"	½"	25	200
690529	¾" Brass Tee	¾"	¾"	¾"	10	100
690537	1" Brass Tee	1"	1"	1"	10	50
690545	1 ¼" Brass Tee	1 ¼"	1 ¼"	1 ¼"	2	20
690552	1 ½" Brass Tee	1 ½"	1 ½"	1 ½"	2	20
690560	2" Brass Tee	2"	2"	2"	2	10

## F1960 Brass Expansion Tee

Lead-Free Brass Fittings



Item Number	Description	Size A	Size B	Size C	Sales Pack (Bag QTY)	Box QTY
690586	Wavin A-Pex NLB TEE ¾" x ½" x ½"	½"	¾"	½"	10	150
690594	Wavin A-Pex NLB TEE ¾" x ½" x ¾"	½"	¾"	¾"	10	100
690628	Wavin A-Pex NLB TEE 1" x ¾" x ¾"	¾"	¾"	1"	10	50
690636	Wavin A-Pex NLB TEE 1" x ¾" x 1"	¾"	1"	1"	10	50

**Lead free:** Brass that conforms with NSF/ANSI 372 and U.S. Safe Drinking Water Act of the United States.



# Brass Cold Expansion Fittings

## F1960 Brass Expansion Reducing Tee

Lead-Free Brass Fittings



Item Number	Description	Size A	Size B	Size C	Sales Pack (Bag QTY)	Box QTY
690578	1/2" x 1/2" x 3/4" Brass Reducing Tee	1/2"	1/2"	3/4"	10	150
690602	3/4" x 3/4" x 1/2" Brass Reducing Tee	3/4"	3/4"	1/2"	10	100
690610	3/4" x 3/4" x 1" Brass Reducing Tee	3/4"	3/4"	1"	10	50
690644	1" x 1" x 1/2" Brass Reducing Tee	1"	1"	1/2"	10	50
690651	1" x 1" x 3/4" Brass Reducing Tee	1"	1"	3/4"	10	50
690669	1 1/4" x 1 1/4" x 3/4" Brass Reducing Tee	1 1/4"	1 1/4"	3/4"	2	50
690677	1 1/2" x 1 1/2" x 3/4" Brass Reducing Tee	1 1/2"	1 1/2"	3/4"	2	30
690685	1 1/2" x 1 1/2" x 1" Brass Reducing Tee	1 1/2"	1 1/2"	1"	2	30
690693	1 1/2" x 1 1/2" x 1 1/4" Brass Reducing Tee	1 1/2"	1 1/2"	1 1/4"	2	30
690701	2" x 2" x 1" Brass Reducing Tee	2"	2"	1"	2	20

## F1960 Brass Plug

Lead-Free Brass Fittings



Item Number	Description	Size	Sales Pack (Bag QTY)	Box QTY
690719	1/2" Plug	1/2"	25	800
690727	3/4" Plug	3/4"	25	300
690735	1" Plug	1"	10	150

## F1960 Brass Coupling w/ Swivel Adapter

Lead-Free Brass Fittings



Item Number	Description	Size	Sales Pack (Bag QTY)	Box QTY
690743	1/2" Coupling w/ Swivel Adapter FPT	1/2" x 1/2"	25	300

## F1960 Brass Swivel Adapter

Lead-Free Brass Fittings



Item Number	Description	Size	Sales Pack (Bag QTY)	Box QTY
690750	3/4" Swivel Adapter FPT	3/4" x 3/4"	25	200

## F1960 Brass Swivel Elbow MPT

Lead-Free Brass Fittings



Item Number	Description	Size	Sales Pack (Bag QTY)	Box QTY
690768	1/2" Swivel Elbow MPT	1/2" x 1/2"	25	300

**Lead free:** Brass that conforms with NSF/ANSI 372 and U.S. Safe Drinking Water Act of the United States.

# PPSU Cold Expansion Fittings

## F1960 PPSU Expansion Coupling

Poly Alloy Fittings



Item Number	Description	Size	Sales Pack (Bag QTY)	Box QTY
680017	½" PPSU Coupling	½" x ½"	25	1000
680025	¾" PPSU Coupling	¾" x ¾"	25	425
680033	1" PPSU Coupling	1" x 1"	10	200
680041	1 ¼" PPSU Coupling	1 ¼" x 1 ¼"	10	140
680058	1 ½" PPSU Coupling	1 ½" x 1 ½"	10	80
680066	2" PPSU Coupling	2" x 2"	5	40

## F1960 PPSU Expansion Reducing Coupling

Poly Alloy Fittings



Item Number	Description	Size A	Size B	Sales Pack (Bag QTY)	Box QTY
680074	½" x ¾" PPSU Reducing Coupling	¾"	½"	25	500
680082	¾" x 1" PPSU Reducing Coupling	1"	¾"	10	220
680090	1 ¼" x 1" PPSU Reducing Coupling	1 ¼"	1"	10	140

## F1960 PPSU Expansion Elbow

Poly Alloy Fittings



Item Number	Description	Size	Sales Pack (Bag QTY)	Box QTY
680108	½" x ½" PPSU Elbow	½"	25	550
680116	¾" x ¾" PPSU Elbow	¾"	10	200
680124	1" x 1" PPSU Elbow	1"	10	120
680132	1 ¼" x 1 ¼" PPSU Elbow	1 ¼"	5	70
680140	1 ½" x 1 ½" PPSU Elbow	1 ½"	1	43
680157	2" x 2" PPSU Elbow	2"	1	17

## F1960 PPSU Plug

Poly Alloy Fittings



Item Number	Description	Size	Sales Pack (Bag QTY)	Box QTY
680165	½" PPSU Plug	½"	50	2000
680173	¾" PPSU Plug	¾"	25	700
680181	1" PPSU Plug	1"	10	350



# PPSU Cold Expansion Fittings

## F1960 PPSU Expansion Tee

Poly Alloy Fittings



Item Number	Description	Size	Sales Pack (Bag QTY)	Box QTY
680199	½" PPSU Tee	½" x ½" x ½"	25	400
680207	¾" PPSU Tee	¾" x ¾" x ¾"	10	160
680215	1" PPSU Tee	1" x 1" x 1"	10	70
680223	1 ¼" PPSU Tee	1 ¼" x 1 ¼" x 1 ¼"	1	40
680439	1 ½" PPSU Tee	1 ½" x 1 ½" x 1 ½"	1	30
680231	2" PPSU Tee	2" x 2" x 2"	1	12

## F1960 PPSU Expansion Reducing Tee

Poly Alloy Fittings



Item Number	Description	Size A	Size B	Size C	Sales Pack (Bag QTY)	Box QTY
680249	½" x ½" x ¾" PPSU Reducing Tee	½"	½"	¾"	10	240
680256	¾" x ½" x ½" PPSU Reducing Tee	¾"	½"	½"	10	240
680264	¾" x ½" x ¾" PPSU Reducing Tee	¾"	½"	¾"	10	180
680272	¾" x ¾" x ½" PPSU Reducing Tee	¾"	¾"	½"	10	200
680280	1" x 1" x ½" PPSU Reducing Tee	1"	1"	½"	10	100
680298	1" x ¾" x ¾" PPSU Reducing Tee	1"	¾"	¾"	10	100
680306	1" x ¾" x 1" PPSU Reducing Tee	1"	¾"	1"	10	90
680314	1" x 1" x ¾" PPSU Reducing Tee	1"	1"	¾"	10	80
680322	1 ¼" x 1 ¼" x 1" PPSU Reducing Tee	1 ¼"	1 ¼"	1"	1	45
680447	1 ½" x 1 ½" x ¾" PPSU Reducing Tee	1 ½"	1 ½"	¾"	1	45
680454	1 ½" x 1 ½" x 1" PPSU Reducing Tee	1 ½"	1 ½"	1"	1	45

## F1960 PPSU Open Multiport Tee

Poly Alloy Fittings



Item Number	Description	Size A	Size B	Sales Pack (Bag QTY)	Box QTY
680330	¾" x Out 2 (½") - Open Multiport Tee	¾"	2 (½")	5	120
680348	¾" x Out 3 (½") - Open Multiport Tee	¾"	3 (½")	5	90

# PPSU Cold Expansion Fittings

## F1960 PPSU Closed Multiport Tee

Poly Alloy Fittings



Item Number	Description	Size A	Size B	Sales Pack (Bag QTY)	Box QTY
680355	¾" x Out 3 (½") - Closed Multiport Tee	¾"	3 (½")	5	120
680363	¾" x Out 4 (½") - Closed Multiport Tee	¾"	4 (½")	5	90

## F1960 PPSU Expansion Ring w/ Stop

Poly Alloy Fittings



Item Number	Description	Size	Sales Pack (Bag QTY)	Box QTY
680371	½" Expansion Ring w/ Stop	½"	50	4000
680389	¾" Expansion Ring w/ Stop	¾"	40	2000
680397	1" Expansion Ring w/ Stop	1"	25	1000
680405	1 ¼" Expansion Ring w/ Stop	1 ¼"	20	500
680413	1 ½" Expansion Ring w/ Stop	1 ½"	8	360
680421	2" Expansion Ring w/ Stop	2"	5	150





# Brass Crimp Fittings

## F1807 Brass Crimp Coupling

Lead-Free Brass Fittings



Item Number	Description	Size	Sales Pack (Bag QTY)	Box QTY
524561	1/2" Brass Coupling	1/2" x 1/2"	25	250
524579	3/4" Brass Coupling	3/4" x 3/4"	25	250
524587	3/4" x 1/2" Brass Coupling	3/4" x 1/2"	25	250
524603	1" Brass Coupling	1" x 1"	10	50
524595	1" x 3/4" Brass Coupling	1" x 3/4"	10	50

## F1807 Brass Crimp Coupling (Pex barb + Poly-B barb)

Lead-Free Brass Fittings



Item Number	Description	Size	Sales Pack (Bag QTY)	Box QTY
524546	1/2" Brass Coupling	1/2" x 1/2"	25	250
524553	3/4" Brass Coupling	3/4" x 3/4"	25	250
524900	1" Brass Coupling	3/4" x 1/2"	10	50

## F1807 Brass Crimp Tee

Lead-Free Brass Fittings

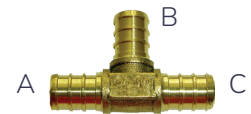

Item Number	Description	Size A	Size B	Size C	Sales Pack (Bag QTY)	Box QTY
524439	1/2" x 1/2" x 1/2" Brass Tee	1/2"	1/2"	1/2"	25	250
524447	1/2" x 1/2" x 3/4" Brass Tee	1/2"	1/2"	3/4"	25	250
524454	3/4" x 3/4" x 3/4" Brass Tee	3/4"	3/4"	3/4"	25	250
524462	3/4" x 1/2" x 1/2" Brass Tee	3/4"	1/2"	1/2"	25	250
524470	3/4" x 1/2" x 3/4" Brass Tee	3/4"	1/2"	3/4"	25	250
524488	3/4" x 3/4" x 1/2" Brass Tee	3/4"	3/4"	1/2"	10	50
524850	3/4" x 3/4" x 1" Brass Tee	3/4"	3/4"	1"	10	50
524504	1" x 1" x 1" Brass Tee	1"	1"	1"	10	50
524843	1" x 3/4" x 1/2" Brass Tee	1"	3/4"	1/2"	10	50
524512	1" x 3/4" x 3/4" Brass Tee	1"	3/4"	3/4"	10	50
524835	1" x 3/4" x 1" Brass Tee	1"	3/4"	1"	10	50
524520	1" x 1" x 1/2" Brass Tee	1"	1"	1/2"	10	50
524538	1" x 1" x 3/4" Brass Tee	1"	1"	3/4"	10	50

Lead free: Brass that conforms with NSF/ANSI 372 and U.S. Safe Drinking Water Act of the United States.

# Brass Crimp Fittings

## F1807 Brass Crimp 90° Elbow

Lead-Free Brass Fittings



Item Number	Description	Size A	Size B	Sales Pack (Bag QTY)	Box QTY
524363	½" x ½" Brass 90° Elbow+A37	½"	½"	25	250
524371	¾" x ¾" Brass 90° Elbow	¾"	¾"	25	250
524389	¾" x ½" Brass 90° Elbow	¾"	½"	25	250
524405	¾" x 1" Brass 90° Elbow	¾"	1"	10	50
524397	1" x 1" Brass 90° Elbow	1"	1"	10	50

## F1807 Brass Crimp 90° Elbow (barb + MPT)

Lead-Free Brass Fittings



Item Number	Description	Size A	Size B	Sales Pack (Bag QTY)	Box QTY
524678	½" x ½" Brass 90° Elbow	½"	½"	10	50
524827	¾" x ¾" Brass 90° Elbow	¾"	¾"	25	100

## F1807 Brass Crimp 90° Elbow (Female Sweat x Pex Barb)

Lead-Free Brass Fittings



Item Number	Description	Size A	Size B	Sales Pack (Bag QTY)	Box QTY
524801	½" x ½" Brass 90° Elbow	½"	½"	25	250
524819	¾" x ¾" Brass 90° Elbow	¾"	¾"	25	250

## F1807 Brass Crimp 90° Elbow (Male Sweat x Pex Barb)

Lead-Free Brass Fittings



Item Number	Description	Size A	Size B	Sales Pack (Bag QTY)	Box QTY
524777	½" x ½" Brass 90° Elbow	½"	½"	25	250
524785	¾" x ¾" Brass 90° Elbow	¾"	¾"	25	250

## F1807 Brass Crimp Wing Elbow

Lead-Free Brass Fittings

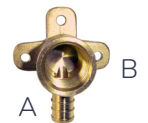

Item Number	Description	Size A	Size B	Sales Pack (Bag QTY)	Box QTY
524322	½" Brass Wing Elbow	½"	½"	25	100
524348	¾" Brass Wing Elbow	¾"	¾"	25	100
524330	¾" x ½" Brass Wing Elbow	¾"	½"	25	100

Lead free: Brass that conforms with NSF/ANSI 372 and U.S. Safe Drinking Water Act of the United States.



# Brass Crimp Fittings

## F1807 Brass Crimp Sweat Adapter (Barb x Male)

Lead-Free Brass Fittings



Item Number	Description	Size A	Size B	Sales Pack (Bag QTY)	Box QTY
524645	1/2" Brass Sweat Adapter	1/2"	1/2"	25	250
524652	3/4" Brass Sweat Adapter	3/4"	3/4"	25	250
524751	3/4" x 1/2" Brass Sweat Adapter	3/4"	1/2"	25	250
524660	1" Brass Sweat Adapter	3/4"	1"	10	50

## F1807 Brass Crimp Sweat Adapter (Barb x Female)

Lead-Free Brass Fittings



Item Number	Description	Size A	Size B	Sales Pack (Bag QTY)	Box QTY
524140	1/2" Brass Sweat Adapter	1/2"	1/2"	25	250
524157	3/4" Brass Sweat Adapter	3/4"	3/4"	25	250
524165	1" Brass Sweat Adapter	1"	1"	10	50
524173	1" x 3/4" Brass Sweat Adapter	1"	3/4"	10	50

## F1807 Brass Crimp Male Adapter

Lead-Free Brass Fittings



Item Number	Description	Size A	Size B	Sales Pack (Bag QTY)	Box QTY
524181	1/2" Brass Male Adapter	1/2"	1/2"	25	250
524207	1/2" x 3/4" Brass Male Adapter	1/2"	3/4"	25	250
524215	3/4" Brass Male Adapter	3/4"	3/4"	25	250
524223	3/4" x 1/2" Brass Male Adapter	3/4"	1/2"	25	250
524983	3/4" x 1" Brass Male Adapter	3/4"	1"	10	50
524231	1" Brass Male Adapter	1"	1"	10	50
524249	1" x 3/4" Brass Male Adapter	1"	3/4"	10	50

**Lead free:** Brass that conforms with NSF/ANSI 372 and U.S. Safe Drinking Water Act of the United States.

# Brass Crimp Fittings

## F1807 Brass Crimp Female Adapter

Lead-Free Brass Fittings



Item Number	Description	Size A	Size B	Sales Pack (Bag QTY)	Box QTY
524256	3/8" x 1/2" Brass Swivel Adapter	3/8"	1/2"	25	250
524264	1/2" Brass Swivel Adapter	1/2"	1/2"	25	250
524306	1/2" x 3/4" Brass Swivel Adapter	1/2"	3/4"	25	250
524272	3/4" Brass Swivel Adapter	3/4"	3/4"	25	250
524280	3/4" x 1/2" Brass Swivel Adapter	3/4"	1/2"	25	250
524314	3/4" Barb x Swivel	3/4"	3/4"	25	250
524355	3/4 x 1" Brass Swivel Adapter	3/4"	1"	10	50
524991	1" Brass Swivel Adapter	1"	1"	10	50

## F1807 Brass Crimp Swivel Adapter (barb x 90°)

Lead-Free Brass Fittings



Item Number	Description	Size	Sales Pack (Bag QTY)	Box QTY
524793	1/2" x 90° Brass Crimp Swivel Adapter	1/2" x 1/2"	25	250

## F1807 Brass Crimp Swivel Adapter (barb x NPSM)

Lead-Free Brass Fittings



Item Number	Description	Size	Sales Pack (Bag QTY)	Box QTY
524769	1/2" Brass Crimp Swivel Adapter	1/2" x 1/2"	25	250

## F1807 Brass Crimp Plug

Lead-Free Brass Fittings



Item Number	Description	Size	Sales Pack (Bag QTY)	Box QTY
524611	1/2" Brass Plug	1/2" x 1/2"	25	250
524629	3/4" Brass Plug	3/4" x 3/4"	25	250
524637	1" Brass Plug	1" x 1"	10	50

Lead free: Brass that conforms with NSF/ANSI 372 and U.S. Safe Drinking Water Act of the United States.

# Brass Crimp Fittings

## Metallic Crimp Rings

Copper



Item Number	Description	Size	Sales Pack (Bag QTY)	Box QTY
510172	½" Metallic Crimp Ring	½"	100	1000
510180	¾" Metallic Crimp Ring	¾"	100	500
510198	1" Metallic Crimp Ring	1"	100	500

## Stainless Steel Press Sleeves



Item Number	Description	Size	Sales Pack (Bag QTY)	Box QTY
511808	½" Stainless Steel Press Sleeves	½"	25	250
511816	¾" Stainless Steel Press Sleeves	¾"	25	250
511824	1" Stainless Steel Press Sleeves	1"	10	50

**Lead free:** Brass that conforms with NSF/ANSI 372 and U.S. Safe Drinking Water Act of the United States.





# PPSU Crimp Fittings

## F2159 PPSU Crimp Coupling

Pollyalloy Fittings



Item Number	Description	Size	Sales Pack (Bag QTY)	Box QTY
503011	½" PPSU Crimp Coupling	½" x ½"	25	250
503029	¾" PPSU Crimp Coupling	¾" x ¾"	25	250
503037	¾" x ½" PPSU Crimp Coupling	¾" x ½"	25	250
503458	1" PPSU Crimp Coupling	1" x 1"	10	100
503466	1" x ¾" PPSU Crimp Coupling	1" x ¾"	10	100

## F2159 PPSU Crimp Tee

Pollyalloy Fittings



Item Number	Description	Size A	Size B	Size C	Sales Pack (Bag QTY)	Box QTY
503102	½" x ½" x ½" PPSU Crimp Tee	½"	½"	½"	25	250
503169	½" x ½" x ¾" PPSU Crimp Tee	½"	½"	¾"	25	250
503110	¾" x ¾" x ¾" PPSU Crimp Tee	¾"	¾"	¾"	25	250
503177	¾" x ½" x ½" PPSU Crimp Tee	¾"	½"	½"	25	250
503185	¾" x ½" x ¾" PPSU Crimp Tee	¾"	½"	¾"	25	250
503193	¾" x ¾" x ½" PPSU Crimp Tee	¾"	¾"	½"	25	250
503201	1"x 1" x 1" PPSU Crimp Tee	1"	1"	1"	10	100
503227	1" x ¾" x ¾" PPSU Crimp Tee	1"	¾"	¾"	10	100
503235	1"x 1" x ½" PPSU Crimp Tee	1"	1"	½"	10	100
503219	1"x 1" x ¾" PPSU Crimp Tee	1"	1"	¾"	10	100

## F2159 PPSU Crimp Coupling

Pollyalloy Fittings



Item Number	Description	Size A	Size B	Sales Pack (Bag QTY)	Box QTY
503300	½" x ½" PPSU 90° Elbow	½" x ½"	½"	25	250
503318	¾" x ¾" PPSU 90° Elbow	¾" x ¾"	¾"	25	250
503367	¾" x ½" PPSU 90° Elbow	¾" x ½"	½"	25	250
503375	1" x 1" PPSU 90° Elbow	1" x 1"	1"	10	100

# PPSU Crimp Fittings

## F2159 PPSU Crimp Plug

Pollyalloy Fittings



Item Number	Description	Size	Sales Pack (Bag QTY)	Box QTY
503409	1/2" PPSU Crimp Plug	1/2" x 1/2"	25	250
503417	3/4" PPSU Crimp Plug	3/4" x 3/4"	25	250
503425	1" PPSU Crimp Plug	3/4" x 1/2"	10	100

## F2159 PPSU Male Adapter

Pollyalloy Fittings



Item Number	Description	Size A	Size B	Sales Pack (Bag QTY)	Box QTY
503045	1/2" PPSU Male Adapter	1/2"	1/2"	25	250
503078	1/2" x 3/4" PPSU Male Adapter	1/2"	3/4"	25	250
503052	3/4" PPSU Male Adapter	3/4"	3/4"	25	250
503086	3/4" x 1/2" PPSU Male Adapter	3/4"	1/2"	25	250

## F2159 PPSU Female Faucet Adapter

Pollyalloy Fittings



Item Number	Description	Size	Sales Pack (Bag QTY)	Box QTY
503060	1/2" PPSU Female Faucet Adapter	1/2" x 1/2"	25	250

## F2159 PPSU Male Adapter

Pollyalloy Fittings

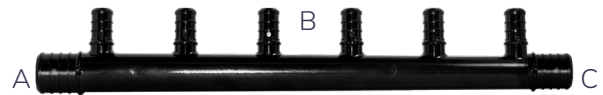

Item Number	Description	Size A	Size B	Size C	Sales Pack (Bag QTY)	Box QTY
503516	3/4"x Out 2 (1/2") - Open Manifold	3/4"	2(1/2")	3/4"	5	120
503524	3/4" x Out 3 (1/2") - Open Manifold	3/4"	3(1/2")	3/4"	5	90
503532	3/4" x Out 4 (1/2") - Open Manifold	3/4"	4(1/2")	3/4"	5	60
503540	3/4" x Out 6 (1/2") - Open Manifold	3/4"	5(1/2")	3/4"	5	30

Wavin A-Pex

PPSU Crimp Fittings

F2159 PPSU Male Adapter

Pollyalloy Fittings



Item Number	Description	Size A	Size B	Sales Pack (Bag QTY)	Box QTY
503474	¾" x Out 2 (½") - Closed Manifold	¾"	2 (½")	5	120
503482	¾" x Out 3 (½") - Closed Manifold	¾"	3 (½")	5	90
503490	¾" x Out 4 (½") - Closed Manifold	¾"	4 (½")	5	60
503508	¾" x Out 6 (1/2") -Closed Manifold	¾"	5 (½")	5	30





# Wavin A-Pex (Pex-a)

## 25 Year Limited Warranty

Subject to the conditions and limitations in this Limited Warranty, Wavin guarantees its PEX pipe, as well as its PEX fittings, against defects resulting exclusively from faulty manufacturing for a period of 25 years from the initial date of sale by Wavin. Wavin will not be liable for damages caused by faulty installation, raw materials or component defect failures.

Defects and failures must be reported to Wavin within 30 calendar days after such failure occurs. The claimant under this Limited Warranty will be required to return the product to Wavin at claimant's expense for analysis by Wavin. If the conditions of this Limited Warranty are met, Wavin will ship, free of charge and freight prepaid, a quantity of product equal to the failed product or will reimburse the purchase price of the failed product at Wavin's option. In no case, will claims for labor charges, consequential property damage or personal injury be honored.

This Warranty is the only Warranty made by Wavin and is expressly in lieu of all other warranties expressed by anyone or implied, including implied warranties of merchantability or fitness for a particular purpose.

The Limited Warranty will only apply:

1. If the product is installed in accordance with good plumbing and heating practices, applicable code requirements and Wavin's current published installation instructions and,
2. If the product is not misused, abused, kinked, mishandled, damaged, improperly stored, or improperly exposed to UV or exposed to excessive heat, cold or pressure or incompatible media. Wavin has no responsibility for the design, administration, results, or evaluation of any test.
3. This Limited Warranty is applicable if the product is only used with other Wavin products and accessories. If Wavin PEX is used in combination with other brands, the warranty will be limited to 10 years from the initial date of sale by Wavin.

WAVIN HAS NO RESPONSIBILITY FOR THE DESIGN, ADMINISTRATION, RESULTS, OR EVALUATION OF ANY TEST. WAVIN MAKES NO WARRANTIES OR REPRESENTATIONS, EXPRESSED OR IMPLIED, AS TO: THE FITNESS OF ANY PRODUCT OR SYSTEM FOR ANY PARTICULAR PURPOSE; THE SUITABILITY OF ANY PRODUCT OR SYSTEM FOR ANY SPECIFIC APPLICATION; OR THE PERFORMANCE OF ANY PRODUCT OR SYSTEM IN ACTUAL CONSTRUCTION. WAVIN WILL NOT BE LIABLE TO ANY PARTY IN STRICT LIABILITY, TORT, CONTRACT, OR ANY OTHER MANNER FOR DAMAGES CAUSED OR CLAIMED TO BE CAUSED AS A RESULT OF ANY DESIGN OR DEFECT IN WAVIN'S PRODUCTS. REPAIR, REPLACEMENT, PARTIAL OR WHOLE REFUND IS THE SOLE AND EXCLUSIVE FORM OF REMEDY AVAILABLE TO CUSTOMER IN CASE OF DEFECTIVE PRODUCTS AND THE CONSEQUENCES THAT MAY ARISE FROM IT.

# Discover our broad portfolio at wavin.us

- Water management
- Heating and cooling
- Water and gas distribution
- Waste water drainage



Wavin is part of Orbia, a community of companies working together to tackle some of the world's most complex challenges. We are bound by a common purpose: To Advance Life Around the World.



Wavin operates a programme of continuous product development, and therefore reserves the right to modify or amend the specification of their products without notice. All information in this publication is given in good faith, and believed to be correct at the time of going to press. However, no responsibility can be accepted for any errors, omissions or incorrect assumptions.

**Wavin** 950 Winter Street, South Entrance 1st Floor, Waltham, MA 02451, United States | 5700 Côte de Liesse Montréal, QC H4T 1B1  
Phone CAN 514-735-7585 / 1800-561-1169 | US 514-735-3632 / 1800-763-3632 |  
E-mail [customer.service@orbia.com](mailto:customer.service@orbia.com) | [wavin.us](http://wavin.us) | [wavin.ca](http://wavin.ca)

© **Wavin 2025** Wavin reserves the right to make alterations without prior notice. Due to continuous product development, changes in technical specifications may change. Installation must comply with the installation instructions.